

# Solatube<sup>®</sup> HSE Fixed Skylight

## Installation Instructions

Parts List		Quantity
1	HSE Skylight*	(1)
Fasteners		
a.	Flashing Screws - #10 X 2 in (51 mm) (Order Separately)	(8)
2	b. Flashing Screws - #10 X 3 in (76 mm) (Order Separately)	(8)
c. Rubber Foam Self-Stick Insulating Weather Seal 3/4" Wide x 7/16" Thick (Not Provided)		
d. Snap Spacer (Order Separately)		

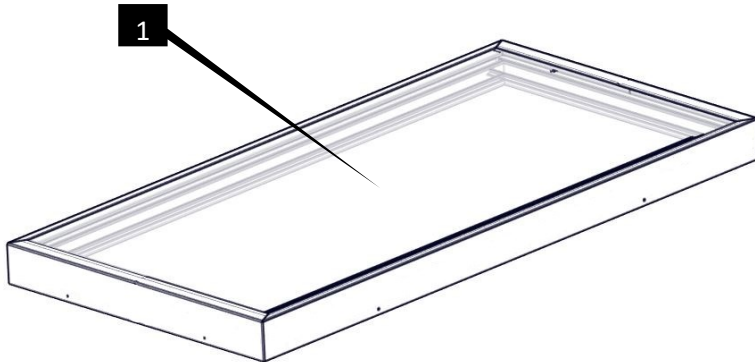

### Required Tools:

Hammer
Flat Bar
Utility Knife
Tape Measure
Screw Gun with Phillips Head
Glass Suction Cup
Required Safety Equipment

**\* High Velocity Hurricane Zones: This product is not rated for High Velocity Hurricane Zones.**

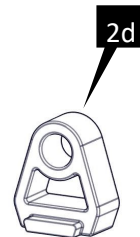
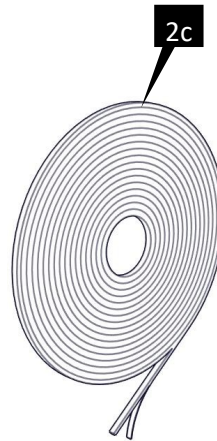
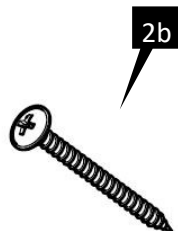
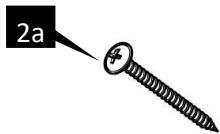

Scan The Code And Watch Our Installation Video





**SOLATUBE**  
Innovation in Daylighting.

# Solatube® HSE Operable Skylight Installation Instructions

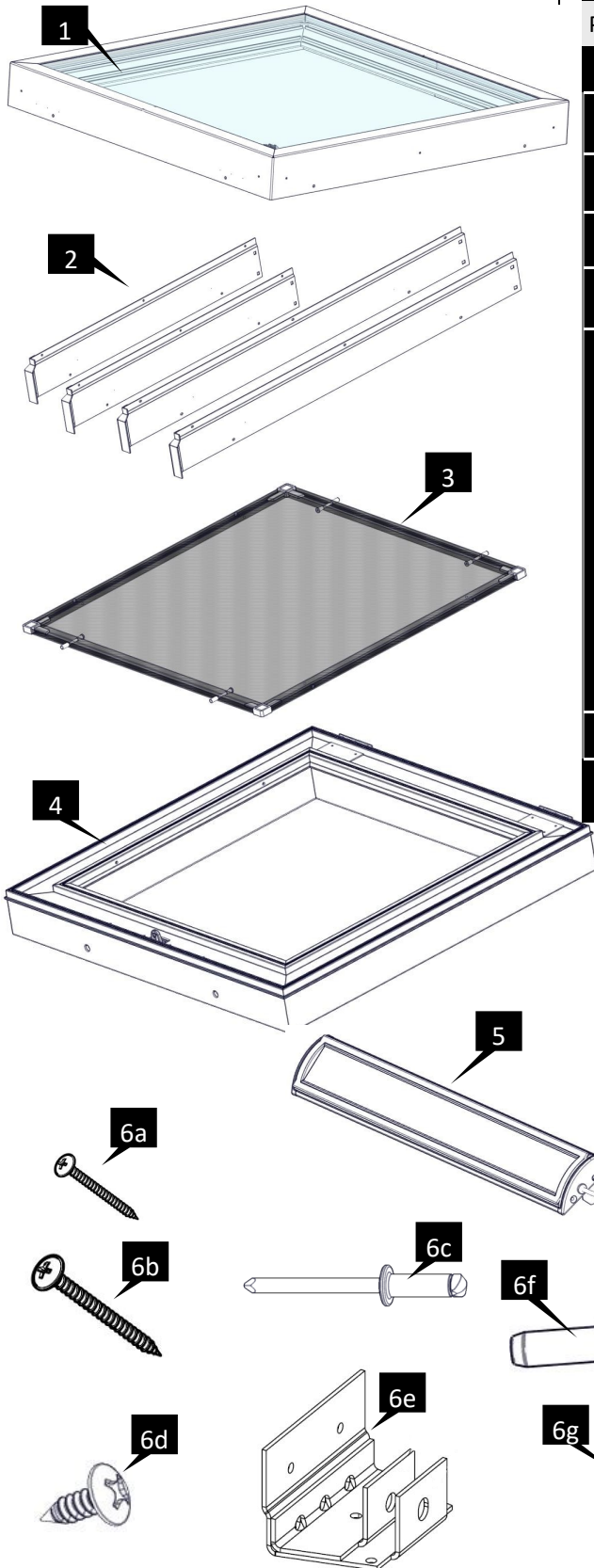

Parts List	Quantity
1 HSE Fixed Skylight Top*	(1)
2 Operable Flash	(4)
3 Skylight Screen	(1)
4 Extrusion Skylight Operable	(1)
5 Solar Panel Assembly with Rain Sensor (Rain Sensor Not Shown)	(1)
6 Fasteners	
a. Flashing Screws - #10 X 2 in (51 mm) (Order Separately)	(8)
b. Flashing Screws - #10 X 3 in (76 mm) (Order Separately)	(8)
c. Rivet, Stainless Steel 1/8" X 5/16"	(12)
d. Screw, Stainless Steel #8 X 1/2" Self-Tapping (Black)	(24)
e. Chain Connector Assembly	(1)
f. Clevis Pin	(1)
g. Snap Spacer (Order Separately)	
7 Skylight Remote Control	(1)
8 b. Rubber Foam Self-Stick Insulating Weather Seal 3/4" Wide x 7/16" Thick (Not Provided)	

## Required Tools:

Rivet Gun
Screw Gun with Phillips Head
Glass Suction Cup
Drill Bit
Utility Knife
Tape Measure
Flat Bar
Hammer
Required Safety Equipment

\* High Velocity Hurricane Zones: This product is not rated for High Velocity Hurricane Zones.

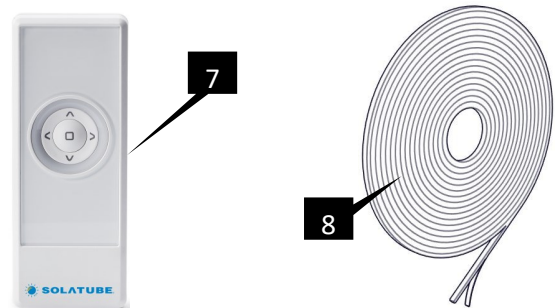

For the most current Installation Instructions, please visit [www.solatube.com/instructions](http://www.solatube.com/instructions)

Solatube International, Inc. | 2210 Oak Ridge Way | Vista, CA 92081-8341 | [www.solatube.com](http://www.solatube.com) | T: 888.SOLATUBE

# **WARNING**



**Do not proceed with the installation until you have read the entire instructions, including these warnings. (Use of materials or methods not authorized by Solatube International will result in an invalid warranty.)**

Solatube International, Inc. (seller) assumes no responsibility or obligation whatsoever for the failure of an architect, contractor, installer, or building owner to comply with all applicable laws, ordinances, building codes, electrical codes, energy codes, fire and safety codes and requirements, roof warranties and adequate safety precautions. Installation of this product should be attempted only by individuals skilled in the use of the tools and equipment necessary for installation. Protect yourself and all persons and property during installation. If you have any doubt concerning your competence or expertise, consult a qualified expert before proceeding.



## **Install at your own risk!**

Solatube product installations may be dangerous and include the potential for death, personal injury and property damage. The hazardous conditions include but are not limited to the following:

- **Use extreme caution when working around the roof opening to prevent falling and personal injury.**
- **The weight of skylights varies, therefore transportation and installation of the skylight to the installation location should be conducted with as many people as necessary to avoid accidents. Ensure proper lifting techniques are used at all times.**
- Solatube products may have sharp edges. Always wear leather or canvas gloves while handling and installing products.
- Solatube product installations require climbing and working at dangerous heights, including on ladders, scaffolding, roofs and in attic spaces. Risk of death, personal injury and property damage may result from a fall, or from falling objects. Use extreme caution to minimize risk of accidental injury, including, but not limited to the following procedures:
  - Clear area below your work space of all people, animals and other items.
  - Avoid working on surfaces that are slippery or wet.
  - Use foot-wear with excellent traction.
  - Use only strong, well supported ladders.
  - Work only in calm dry weather.
  - If attic work is necessary, ensure that your weight is supported at all times with structurally sound framing; drywall material is not designed to carry a person's weight.
- To reduce the risk of fire, electric shock, and personal injury, basic safety precautions should always be followed when using electric tools, including always wearing safety goggles or other suitable eye protection, and ensuring work area is clear of all electrical wires, gas pipes, water pipes, and other obstacles.
- When working in the attic or other dusty areas, use of a mask or respirator is recommended to avoid lung irritation. Attic spaces may be dark, confined, and subject to extreme temperatures. Beware of sharp protruding objects. Do not attempt installation without having someone within range of your voice or close enough to come to your aid if necessary.
- Solatube products are not designed to withstand the weight of a person, tools or other objects. Walking or placing objects on the system could cause personal injury and property damage. If the product is damaged, the structural capacity may be weakened; therefore the system should be repaired immediately. For safe installation and use, do not deviate from these installation instructions.
- Please note that interior surfaces and finishes in older homes may have been painted with lead-based paint. Removal of the skylight could disrupt the paint. Use proper precautions to minimize the exposure of dust and debris when removing and installing skylights. For more information of proper removal of lead paint please visit [www.epa.gov/lead](http://www.epa.gov/lead).
- Ensure roof curb and water proofing is in good condition before installing skylights. If curb and or water proofing is compromised, it will be necessary to repair or replace. All roof work and repairs should be conducted by individuals skilled in roofing practices or a licensed roofer.

For the most current Installation Instructions, please visit [www.solatube.com/installations](http://www.solatube.com/installations)

Solatube International, Inc. | 2210 Oak Ridge Way | Vista, CA 92081-8341 | [www.solatube.com](http://www.solatube.com) | T: 888.SOLATUBE

# Solatube HSE Fixed Skylight Installation Instructions

The following steps are for installation of a Solatube HSE Fixed Skylight.

See page 8 for Solatube HSE Operable Skylight Installation Instruction.

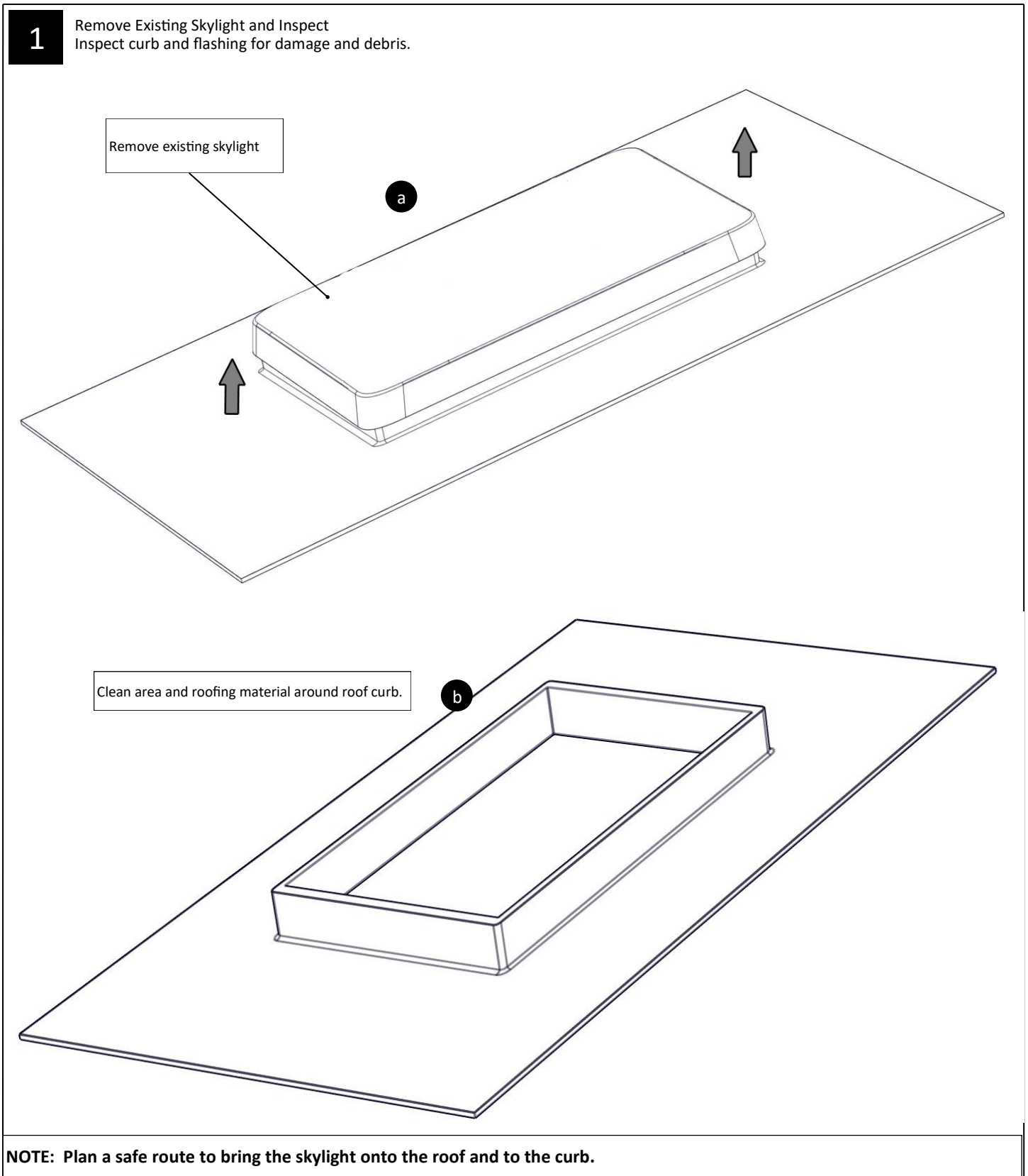

2

Apply New Seal to Top Edge of Roof Curb

Insulating Tape

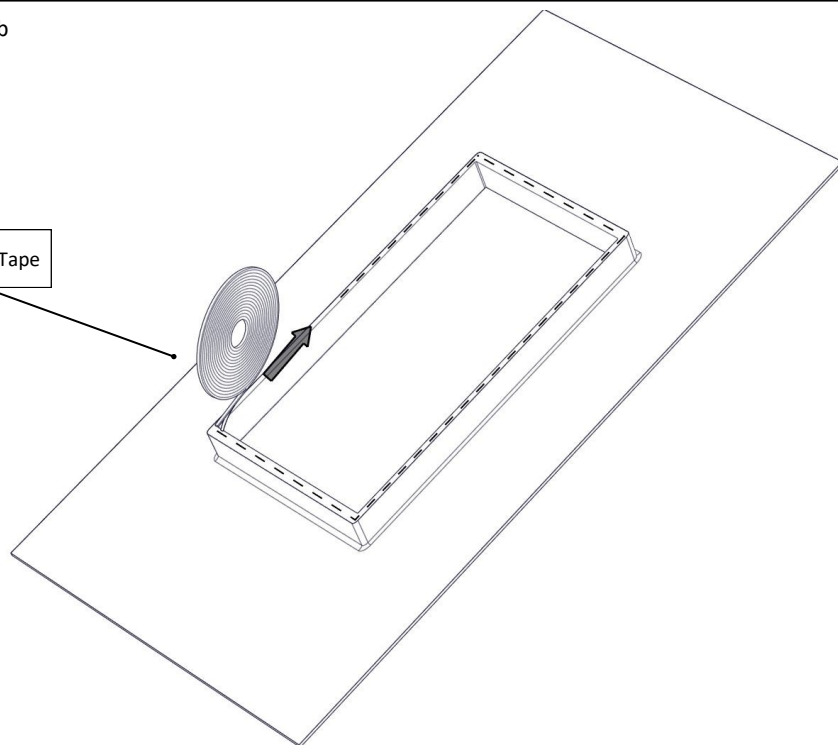

**Caution:** The weight of skylights varies, therefore transportation and installation of the skylight to the installation location should be conducted with as many people as necessary, or utilize lift assisting tools such as hoists to avoid accidents. Ensure proper lifting techniques are used at all times.

3

Return to The Ground Floor to Retrieve the Skylight  
Use glass suction cup to secure and carry skylight to roof. Ensure suction cup is rated appropriately for weight of skylight.

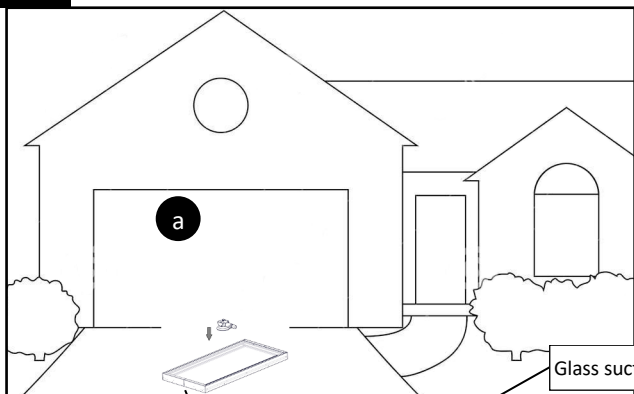

Place suction cup on top 1/3 portion of skylight

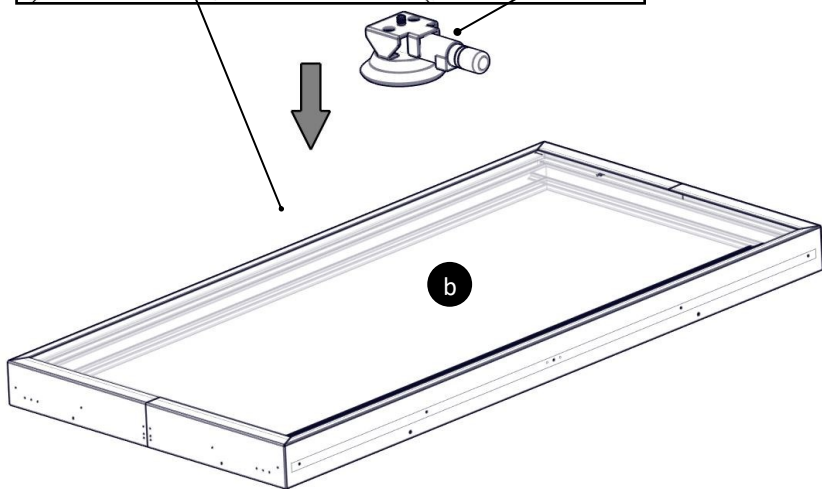
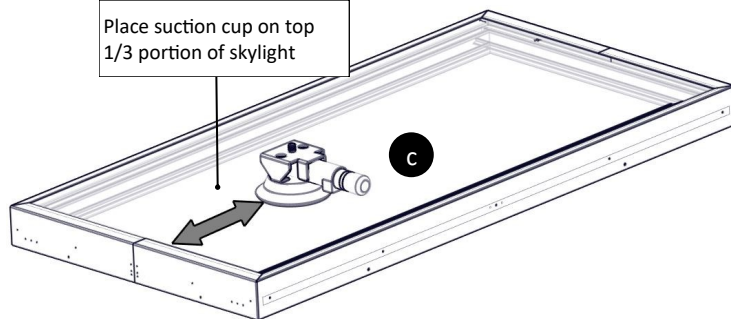

Red line

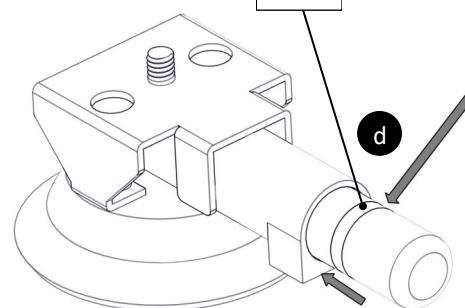

**NOTE:** Pump handle on suction cup until red line is no longer showing. Failure to do so could cause the suction cup to fail and release from the skylight.

4

Return to Roof and Place Skylight Onto Curb  
NOTE: Clean inside glass surface prior to placing onto curb.

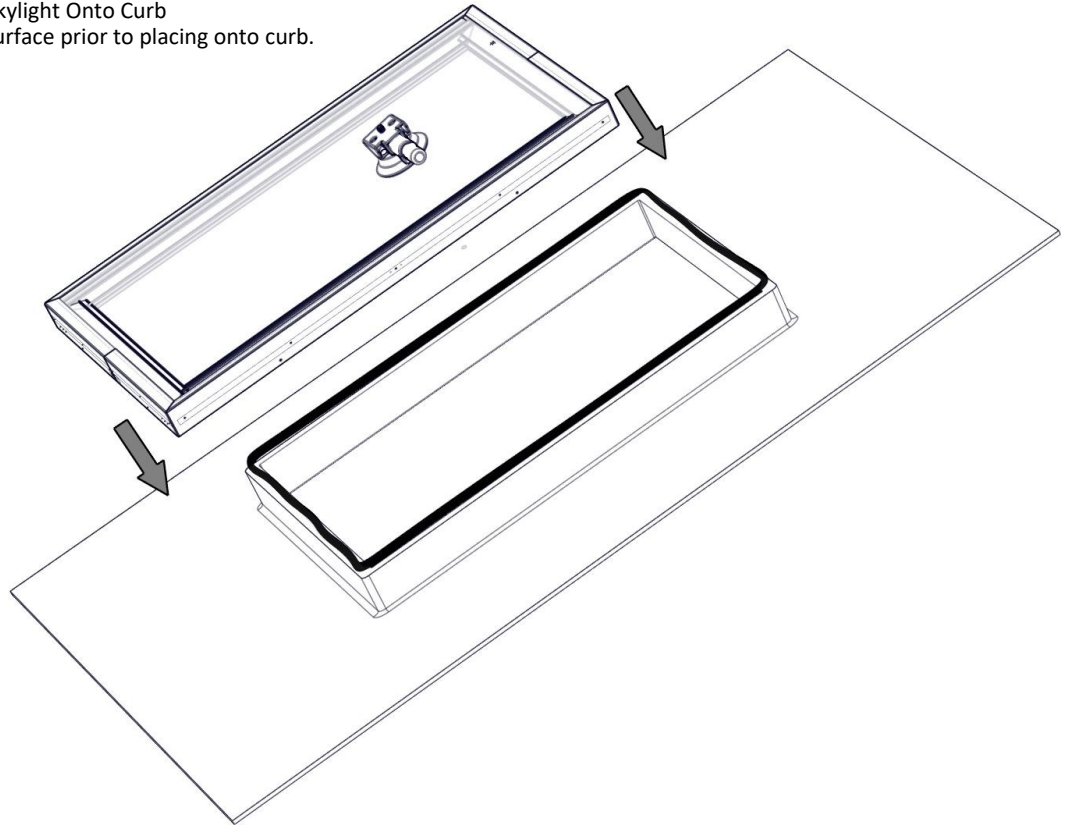

5

Adjust Skylight Position and Fasten to Curb

Use snap spacers as necessary to center skylight to internal drywall. Use multiple spacers for larger gaps between sash and curb. Apply pressure to top of skylight and fasten to curb.

Adjust skylight and center inside frame to drywall.

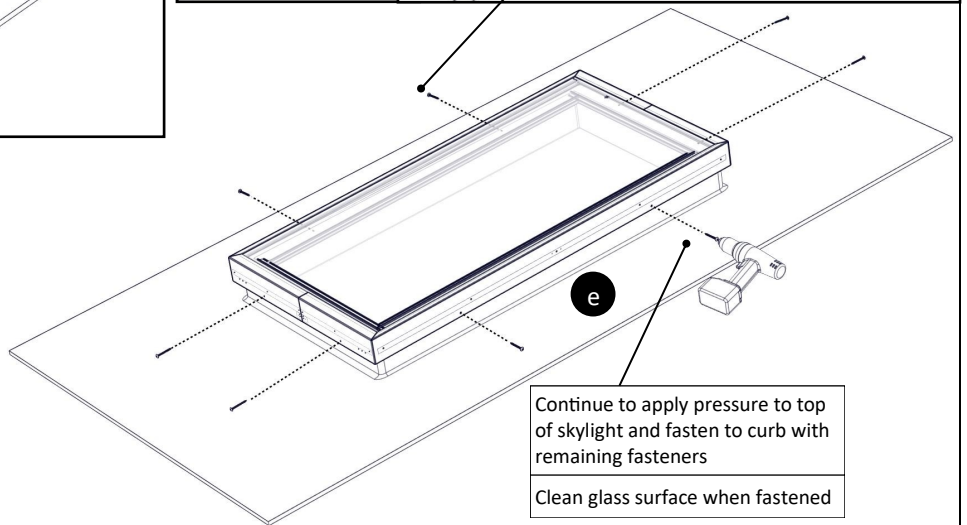
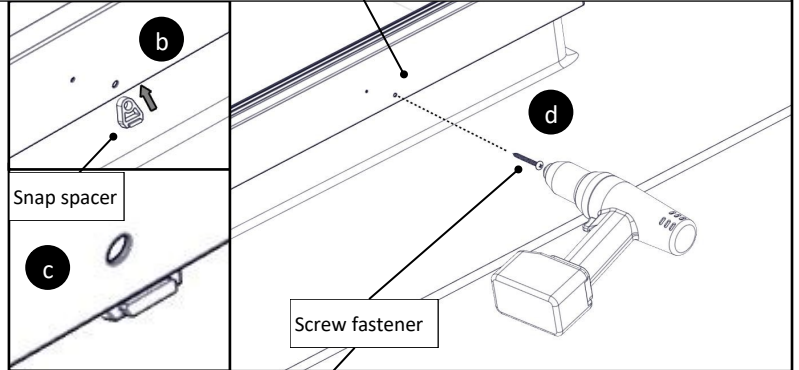
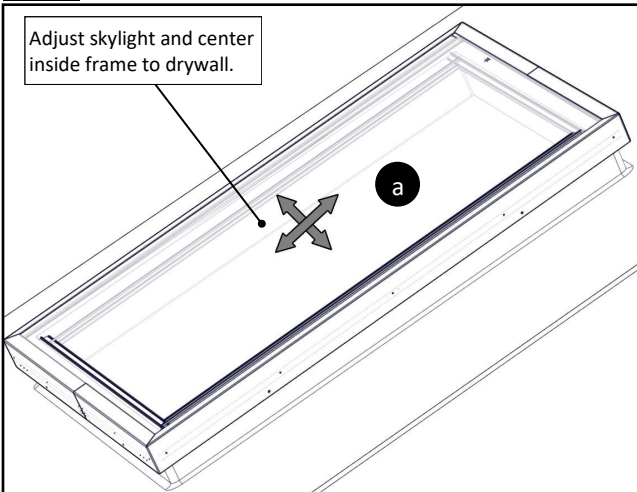

6

For the most current Installation Instructions, please visit [www.solatube.com/instructions](http://www.solatube.com/instructions)  
Solatube International, Inc. | 2210 Oak Ridge Way | Vista, CA 92081-8341 | [www.solatube.com](http://www.solatube.com) | T: 888.SOLATUBE

6

Now you can enjoy the benefits of your Solatube HSE Skylight and the high performance, natural lighting it provides.

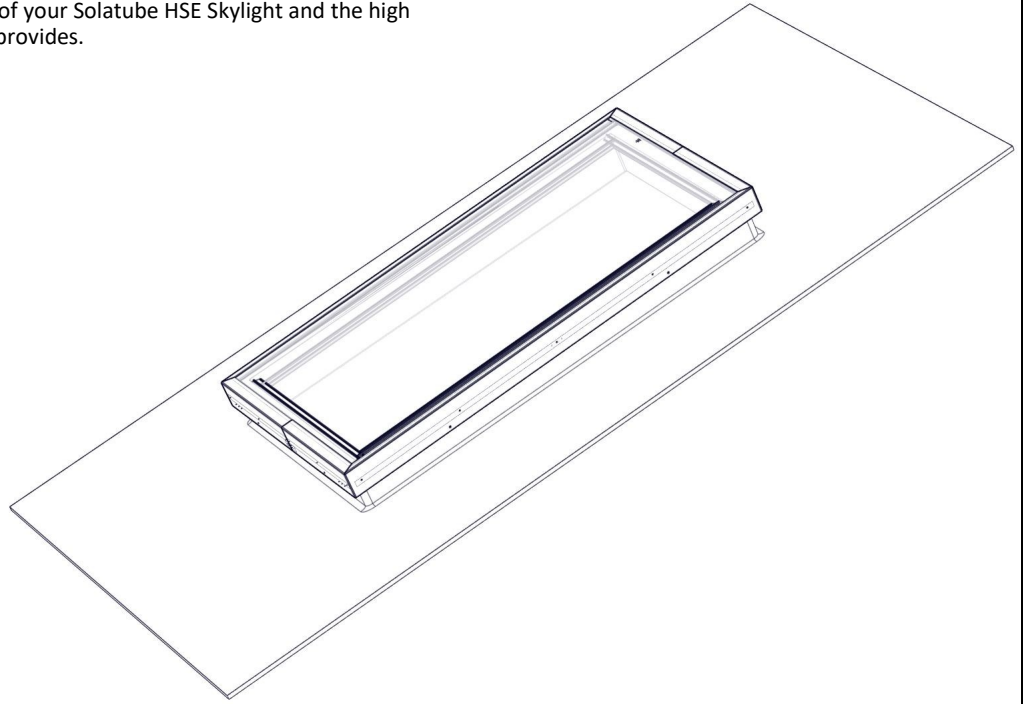

The following steps are for installation of a Solatube HSE Operable Skylight.

1

Remove Existing Skylight  
Inspect curb and flashing for damage and debris. Clean all debris from curb and roof area around skylight opening.  
Apply new seal to top edge of roof curb.



2

Remove All Packaging from Operable Base and Lay Out All Components

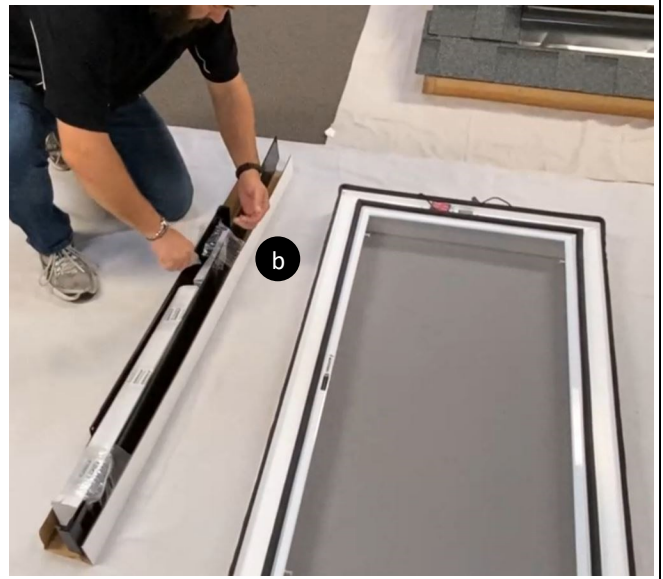

For the most current Installation Instructions, please visit [www.solatube.com/instructions](http://www.solatube.com/instructions)



### 3

#### Check Operation of Solar Motor Prior to Assembly

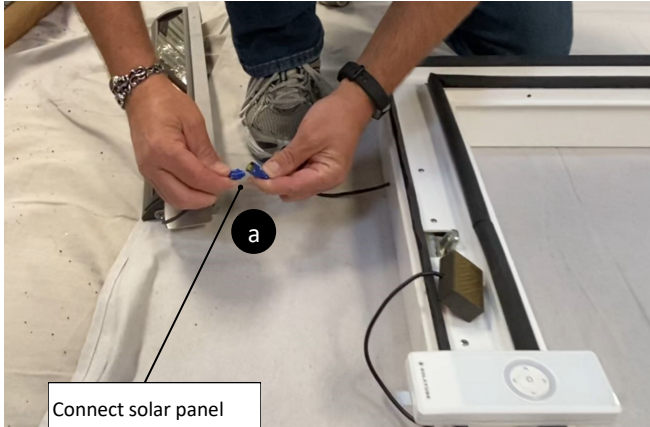

Connect solar panel cable to motor cable

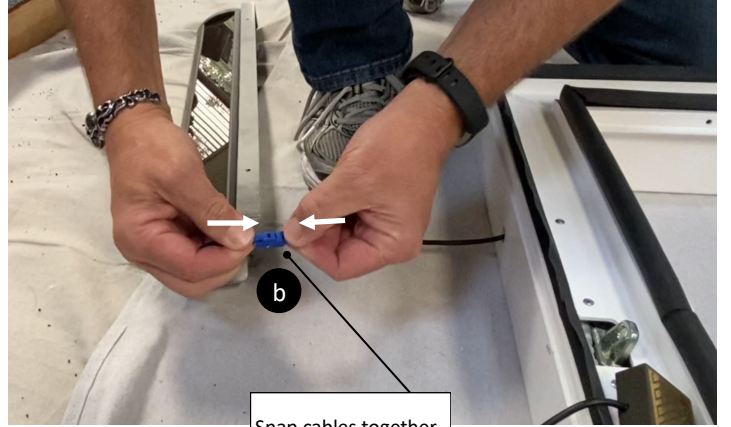

Snap cables together



Remove plastic battery protector

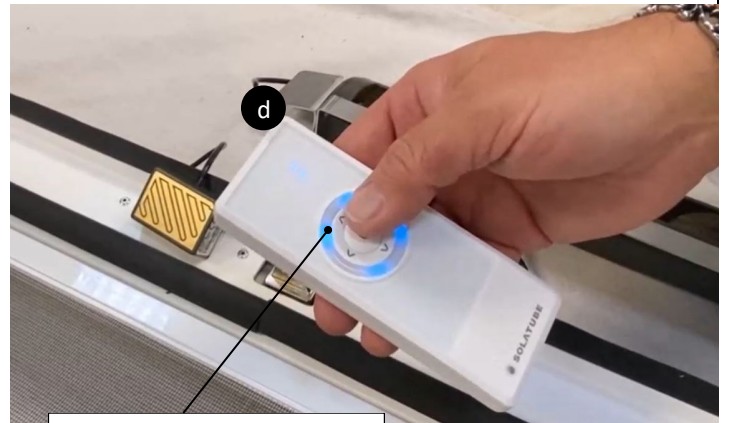

Press the "UP" button to lift the chain

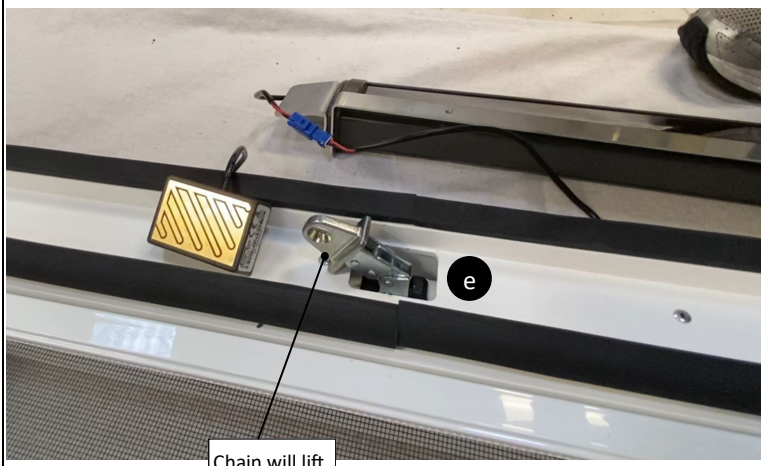

Chain will lift



Press the "DOWN" button to bring the chain back to the home position.  
If motor does not operate, see pairing section on page 21.

**NOTE: If motor does not operate see pairing instruction on page 21.**

4

Assemble the Sash  
Use caution to not flex the plastic corners

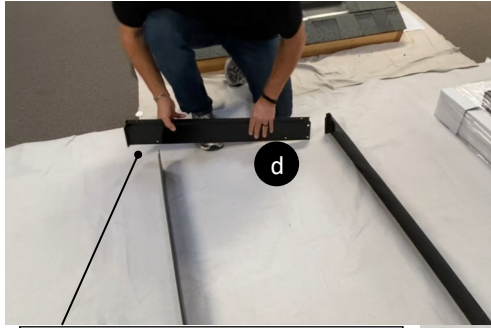
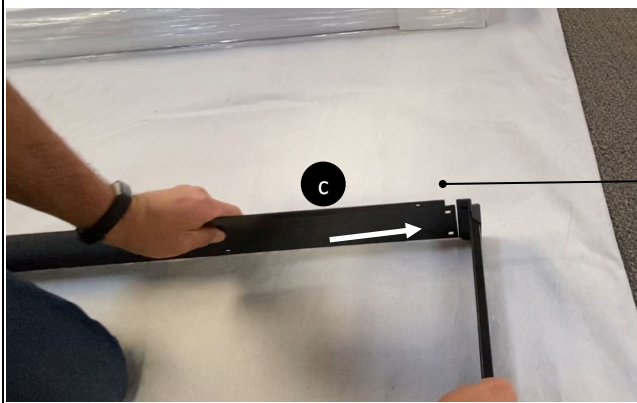
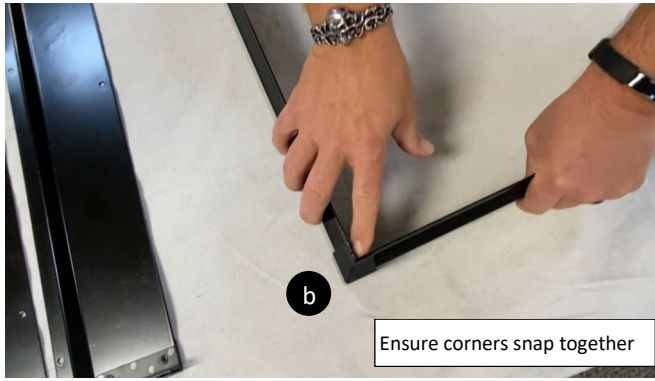
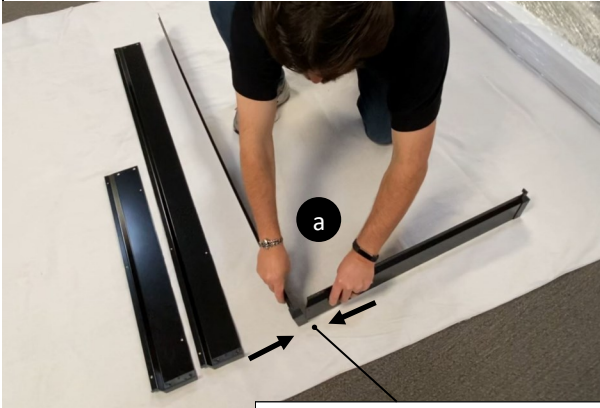

Continue assembling remaining sash sides

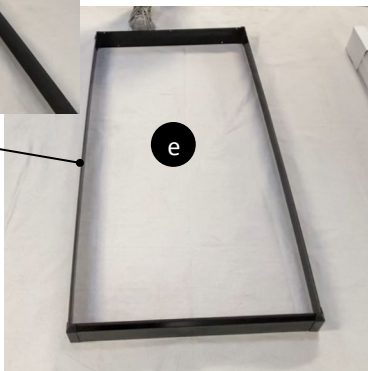

5

Place PVC Base into Sash Frame  
Ensure to keep cords inside of frame

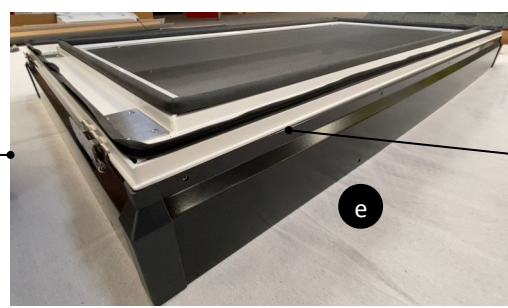
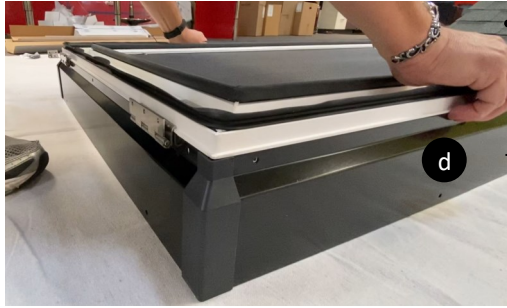
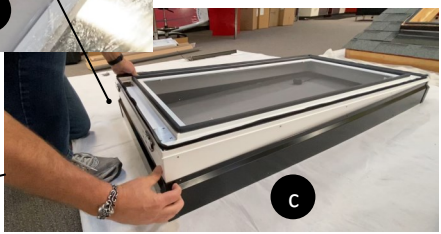
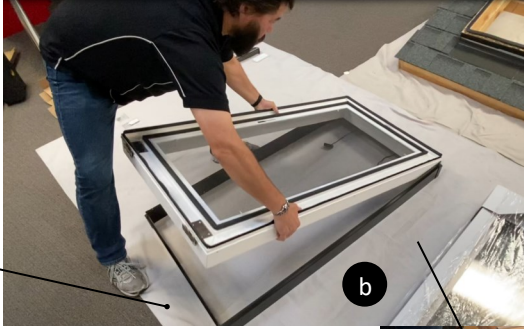

Ensure there is no gap between PVC base and frame.

# 6

## Fasten PVC Base to Sash Frame

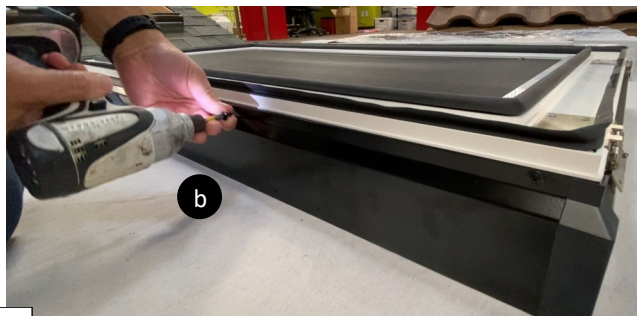
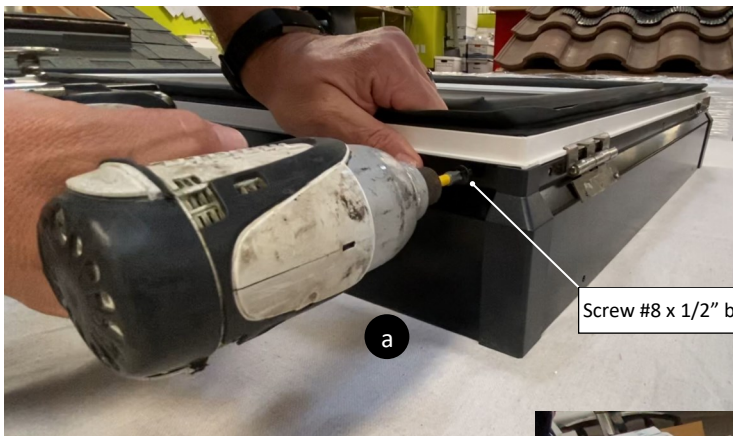

# 7

## Attach Solar Panel to Chain Side of Operable Base Assembly

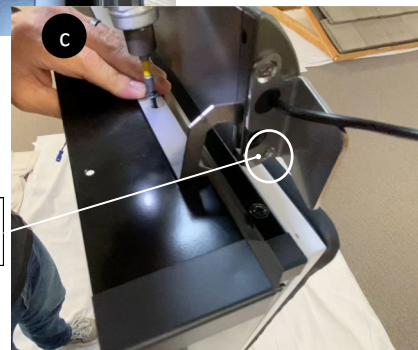
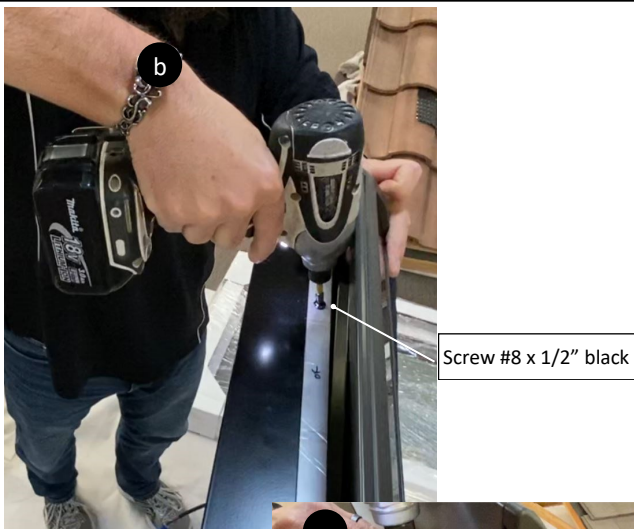

Tighten screws on each side of solar panel to secure correct panel angle for maximum sun exposure.

8

Place Operable Base Assembly on Curb and Align Inside Edges with Drywall Shaft.

 Use the safest method to carry the operable base assembly to the roof.



9

Fasten Operable Base Assembly to Curb  
Use snap spacers to center the operable base assembly to the internal drywall.  
Use multiple spacers for larger gaps between sash and curb.

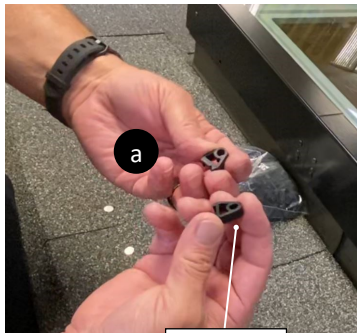

Snap spacer

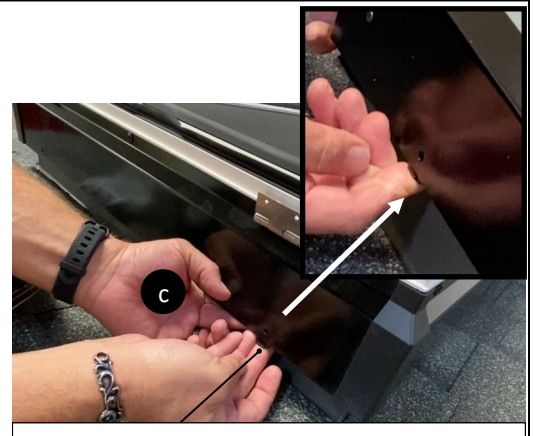

Insert snap spacer(s) between fastening hole and curb

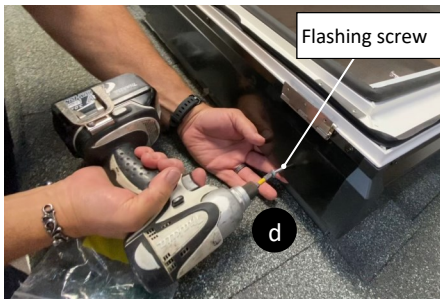

Flashing screw



Press down on top of operable base assembly and fasten to curb.  
Continue fastening all sides of operable base assembly to curb.

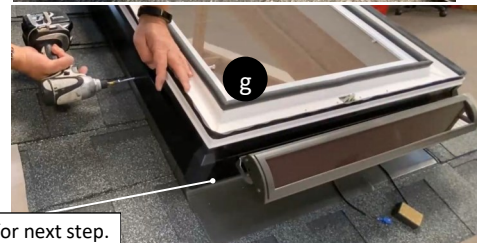

Leave base (lower end with solar panel) for next step.

# 10

## Connect Solar Panel Wire to Motor Wire and Attach Rain Sensor

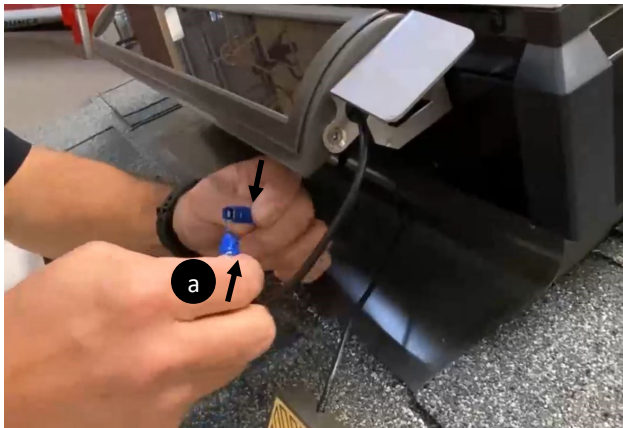

Rain sensor

Remove paper backing from rain sensor and firmly attach

# 11

## Tuck Wires Under Sash and Install Remaining Two (2) Fasteners

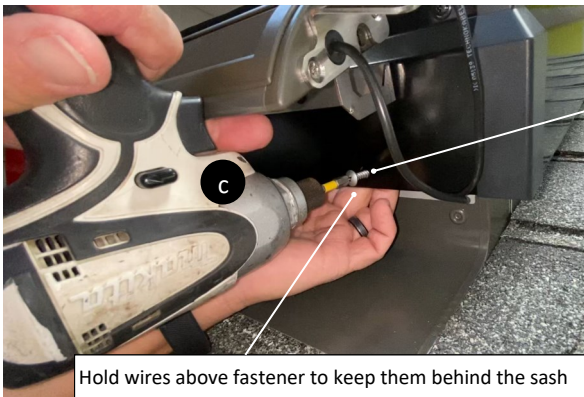

Flashing screw

Hold wires above fastener to keep them behind the sash

12

Lift Hinges to Prepare for Operable Top Installation



Screen can be flipped for access to plunger pins from interior or from roof.



13

Return to Ground Floor and Remove all Packaging from Fixed Skylight Portion

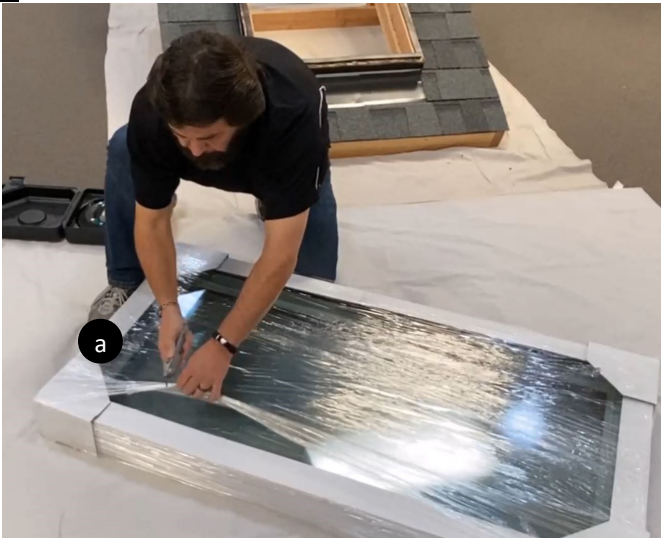

14

Locate Dimples on Fixed Skylight Top and Drill Hinge Holes

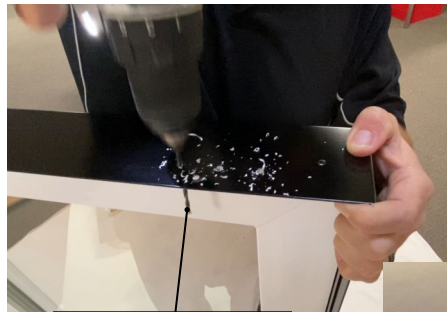
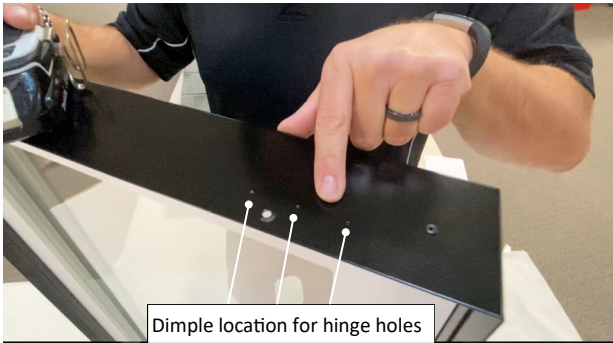

Locate dimple location for hinge holes on opposite end and drill the remaining three hinge holes

14

For the most current Installation Instructions, please visit [www.solatube.com/instructions](http://www.solatube.com/instructions)  
Solatube International, Inc. | 2210 Oak Ridge Way | Vista, CA 92081-8341 | [www.solatube.com](http://www.solatube.com) | T: 888.SOLATUBE

15

Locate Dimples on Opposite Side (Opposite side of hinge holes) of Fixed Skylight Top and Drill Chain Connector Holes



16

Use Chain Connector to Scrape All Debris from the Backside of the Holes Drilled.  
**NOTE: Debris Must be Removed for Chain Connector to be Properly Attached.**



For the most current Installation Instructions, please visit [www.solatube.com/instructions](http://www.solatube.com/instructions)  
Solatube International, Inc. | 2210 Oak Ridge Way | Vista, CA 92081-8341 | [www.solatube.com](http://www.solatube.com) | T: 888.SOLATUBE

17

Use Chain Connector to Scrape All Debris from the Backside of the Hinge Holes Drilled.

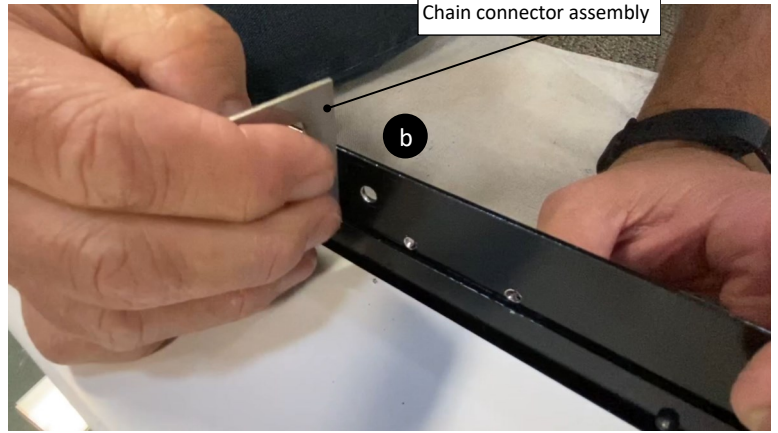

18

Fasten Chain Connector Assembly to the Metal Sash

Place chain connector assembly onto PVC and align with drilled holes

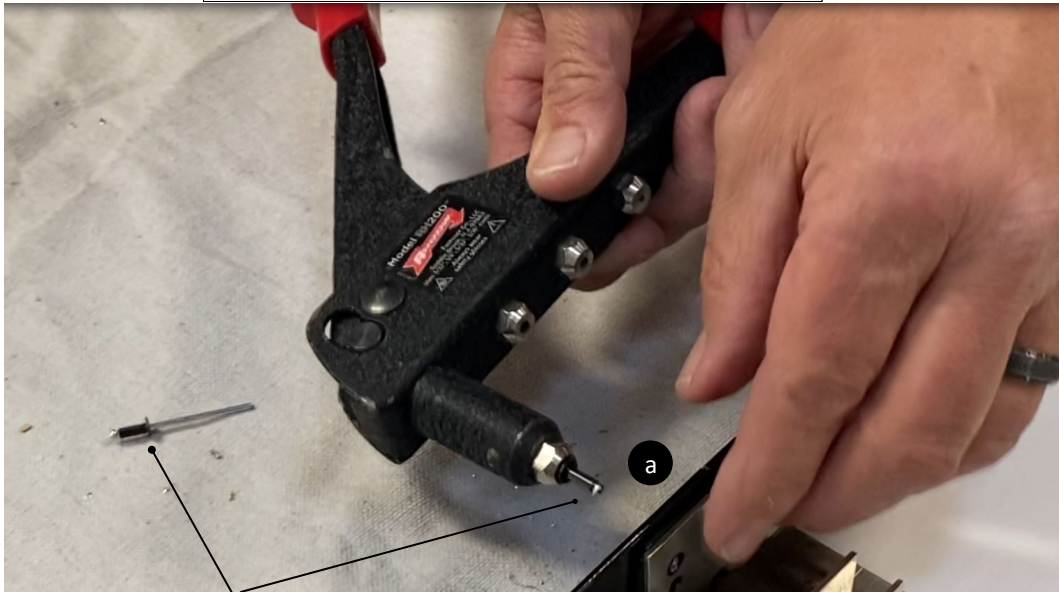

Rivets

Use rivet gun and provided rivets to fasten chain connector

Ensure rivet gun is flush against sash and rivet head is protruding through chain connector. Fasten both drilled holes with rivets

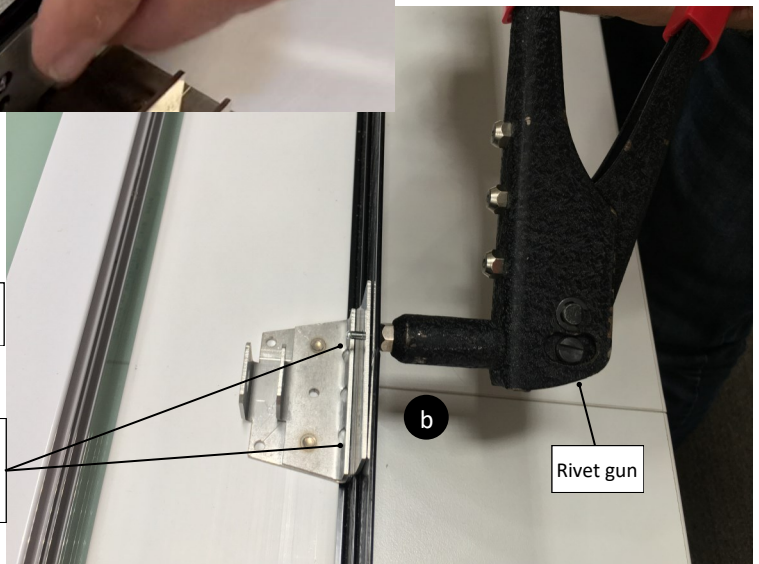

Rivet gun

16

For the most current Installation Instructions, please visit [www.solatube.com/instructions](http://www.solatube.com/instructions)  
Solatube International, Inc. | 2210 Oak Ridge Way | Vista, CA 92081-8341 | [www.solatube.com](http://www.solatube.com) | T: 888.SOLATUBE



19

Drill Through First Layer of PVC and Fasten with Rivets  
Caution: Drill through first layer of PVC only to prevent damage

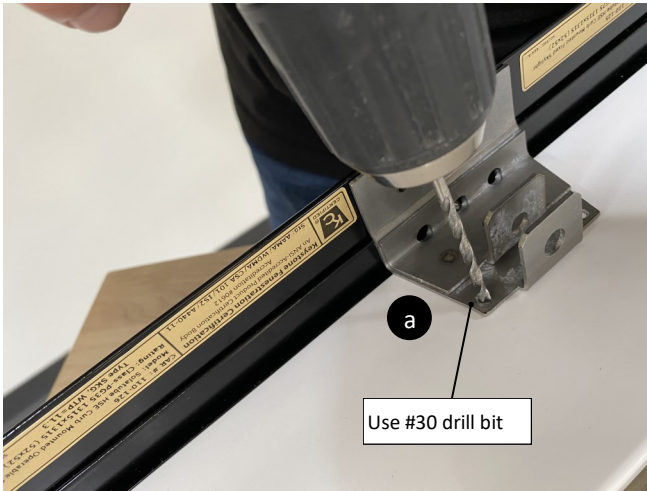

20

Clean the Inside Glass and PVC Frame  
Remove all debris

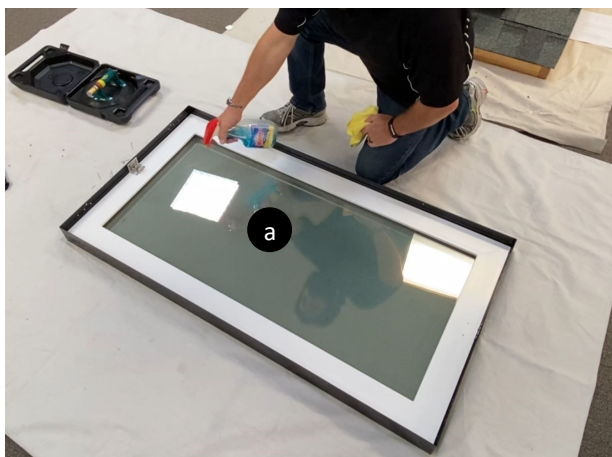

21

Take Fixed Skylight Top to Roof and Place on Operable Base.

 Use the safest method to carry the fixed base assembly to the roof.

Place suction cup on top glass section of fixed top assembly.

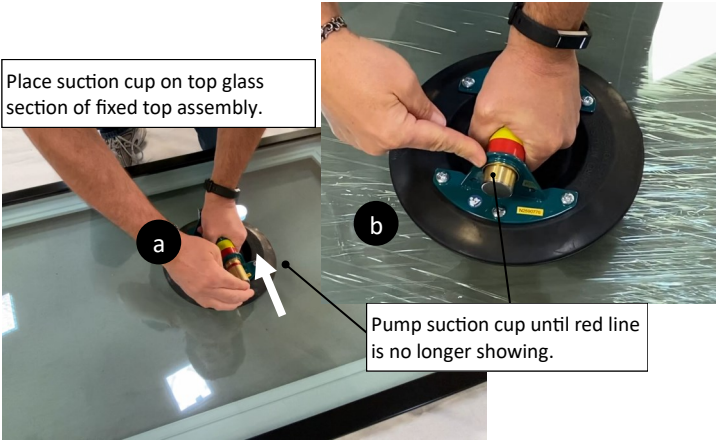

Pump suction cup until red line is no longer showing.



22

Align Sash with Hinge to Ensure Rivet Holes are in Alignment and Fasten. Ensure sash and hinge are flush with no gaps before fastening.

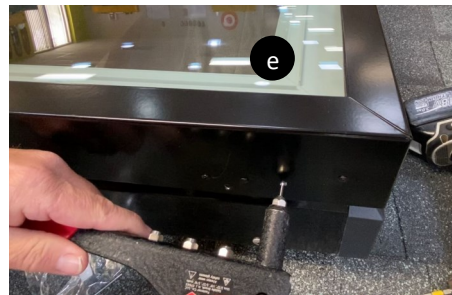
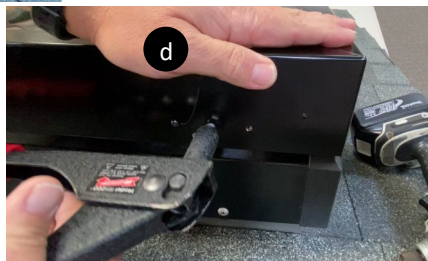
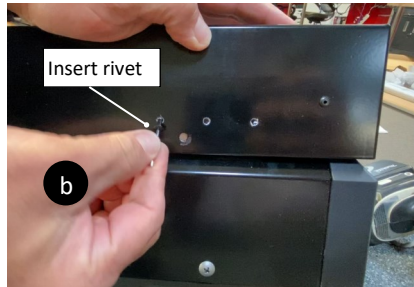
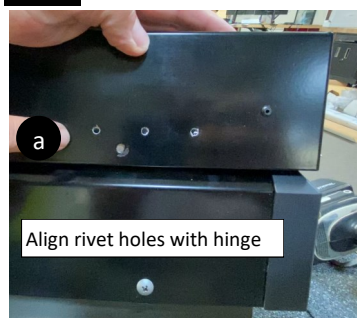

23

Fasten Opposite Hinge to Sash  
Ensure sash and hinge are flush with no gaps before fastening.

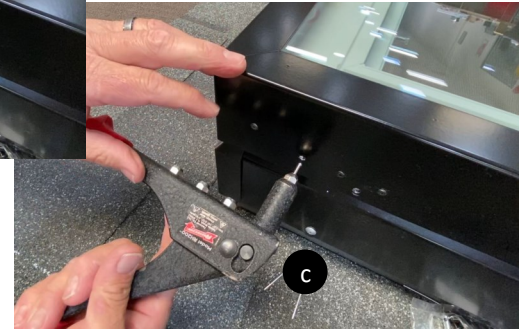
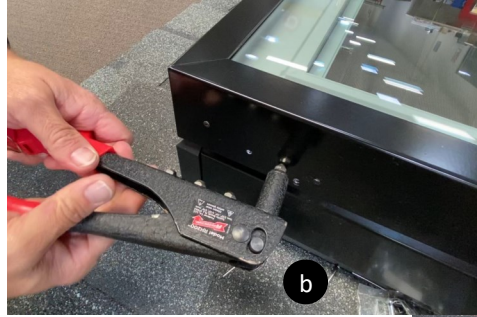
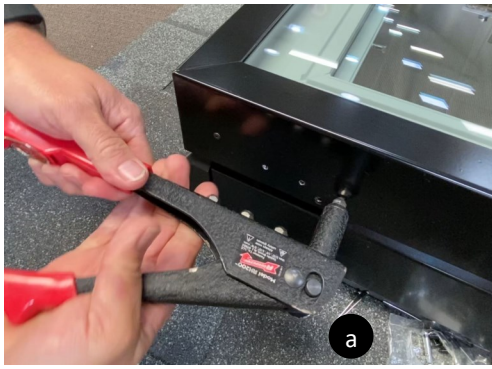

24

Use the Remote to Open the Skylight and Connect Pin

Hold the skylight and guide it as it opens as chain is not pinned yet

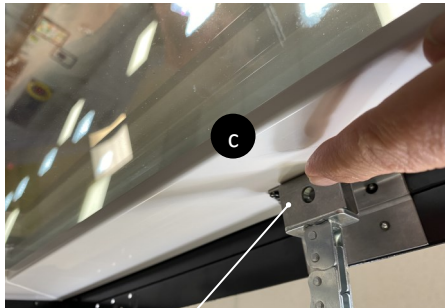
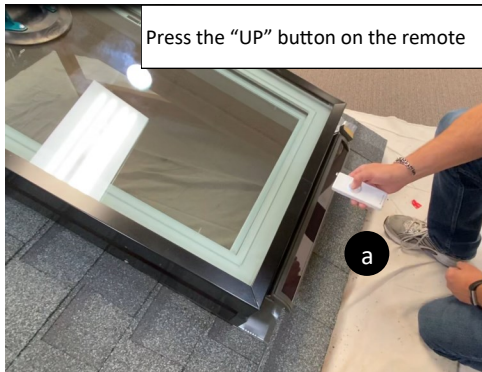

Ensure chain head is in proper location once skylight is fully opened.

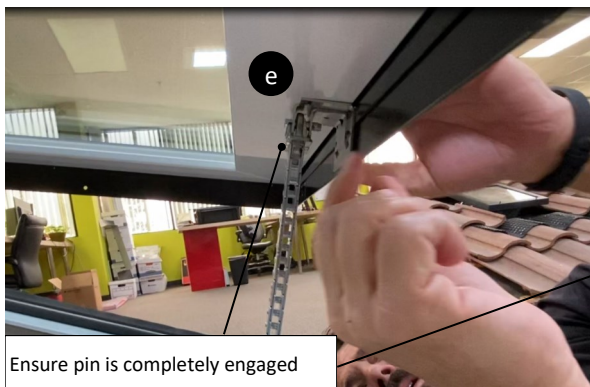
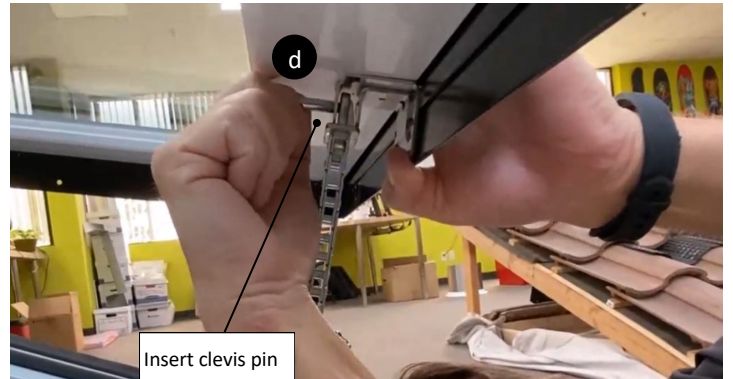

For the most current Installation Instructions, please visit [www.solatube.com/instructions](http://www.solatube.com/instructions)  
Solatube International, Inc. | 2210 Oak Ridge Way | Vista, CA 92081-8341 | [www.solatube.com](http://www.solatube.com) | T: 888.SOLATUBE

25

Press "DOWN" Button on Remote to Close Skylight



26

Remove Suction Cup  
Press button to release suction. Pull suction cup off.



27

Clean Glass and Frame



28

Installation Complete  
You can now enjoy the benefits of your Solatube HSE Operable Skylight and the high performance, natural daylight it provides.



## Optional Step

These instructions are intended to be used to pair multiple Solatube HSE Operable Skylights to one remote control, or pair a new remote.

1

Ensure the Motor and Solar Panel for the Desired Skylight to Pair are Connected.

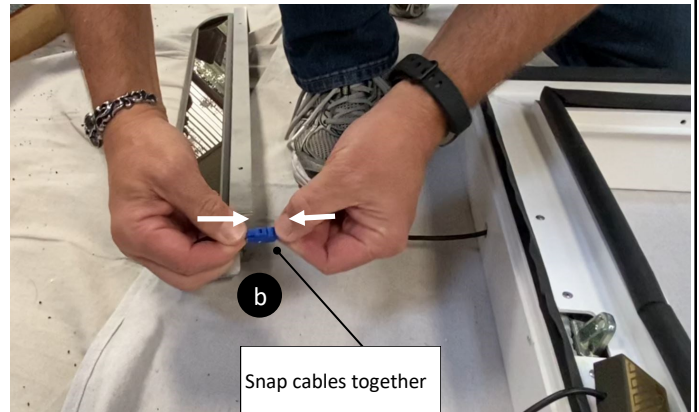
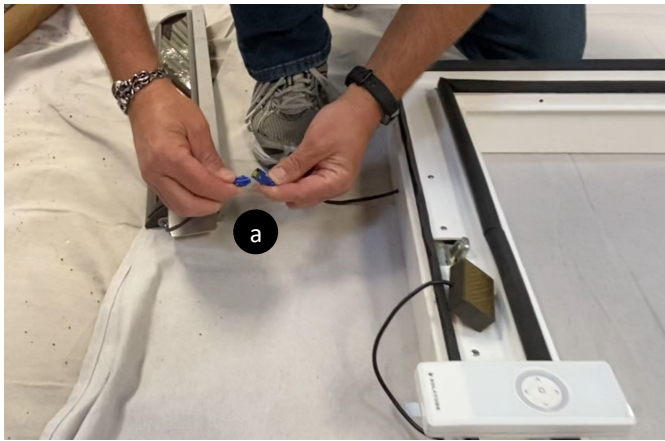

2

Remove Motor Cover, Pairing Chip. Remove Battery Protector from Remote

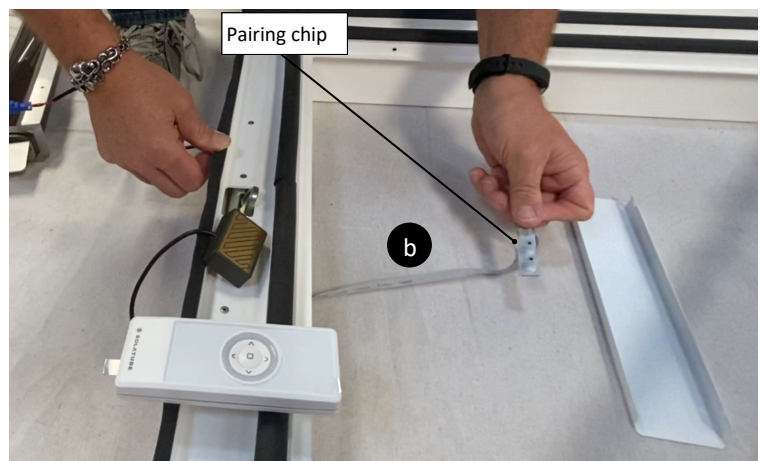
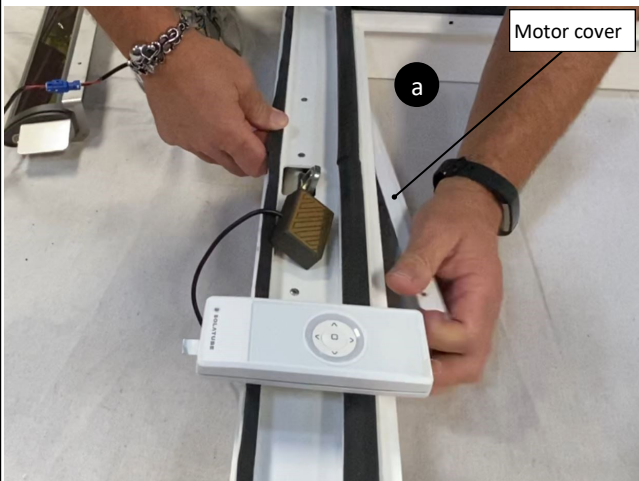

For the most current Installation Instructions, please visit [www.solatube.com/instructions](http://www.solatube.com/instructions)  
Solatube International, Inc. | 2210 Oak Ridge Way | Vista, CA 92081-8341 | [www.solatube.com](http://www.solatube.com) | T: 888.SOLATUBE

### Optional Step—Continued

These instructions are intended to be used to pair multiple Solatube HSE Operable Skylights to one remote control, or pair a new remote.

3

Ensure the Motor and Solar Panel for the Desired Skylight to Pair are Connected.

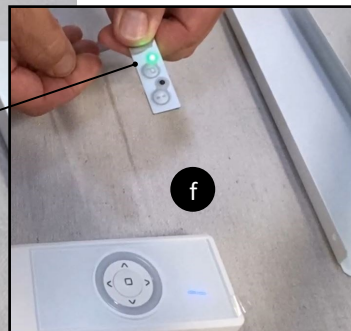
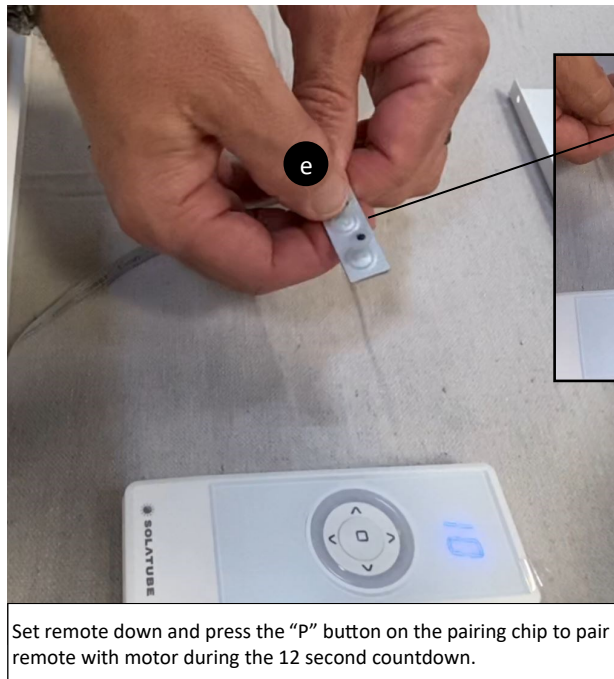
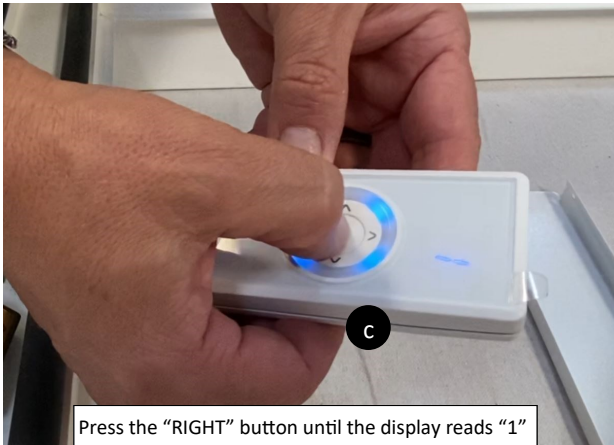
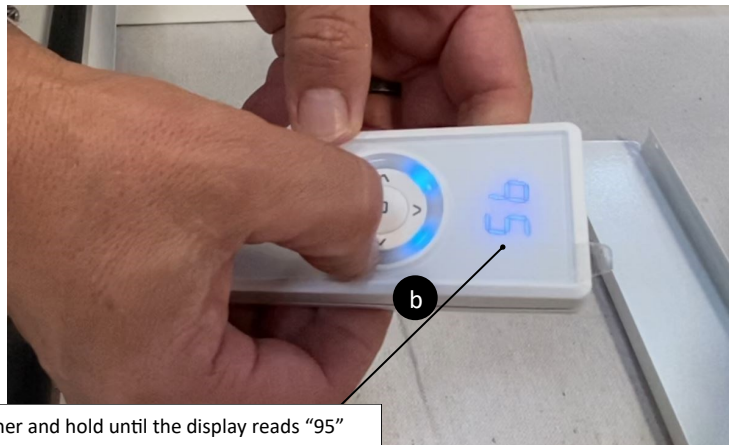
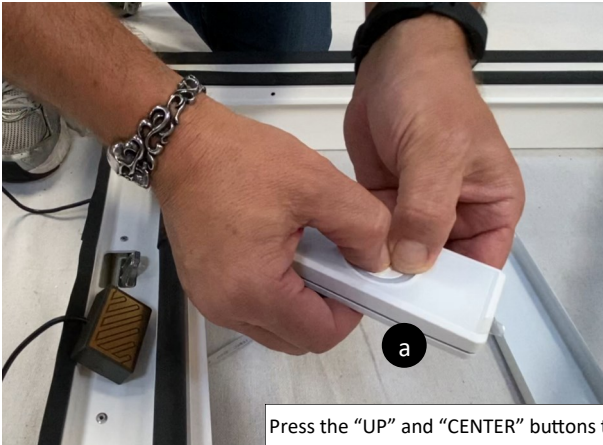

Once paired, the green light and remote display light will turn off to indicate successful pairing.

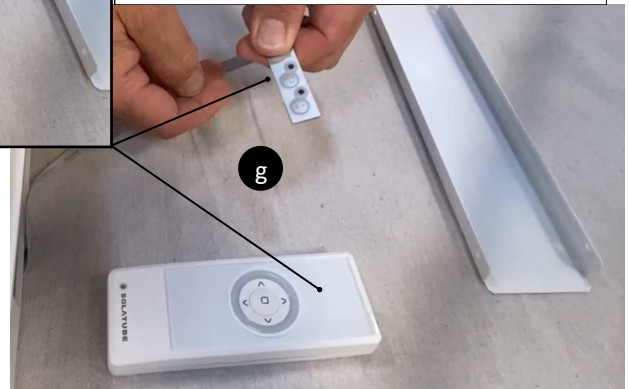

### Optional Step—Continued

These instructions are intended to be used to pair multiple Solatube HSE Operable Skylights to one remote control or pair a new remote.

4

Adjust Chain if Necessary for Chain to Function Properly

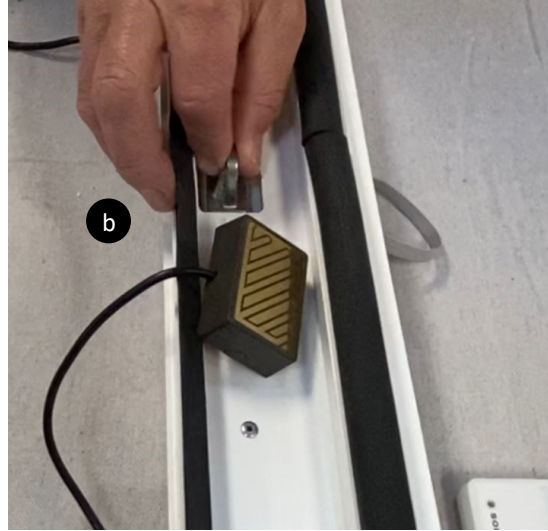
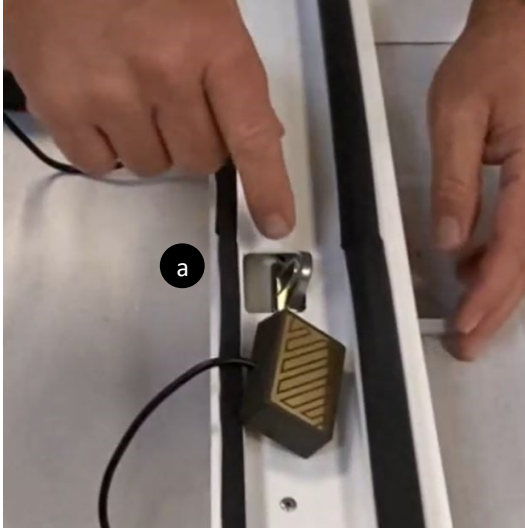

5

Test for Successful Pairing

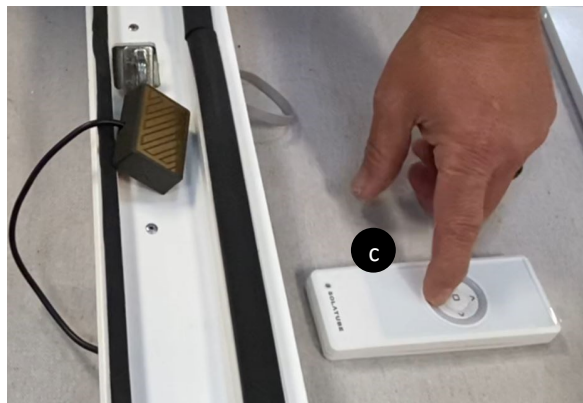
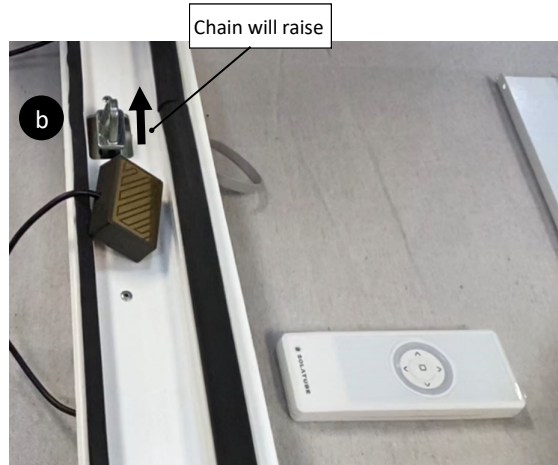
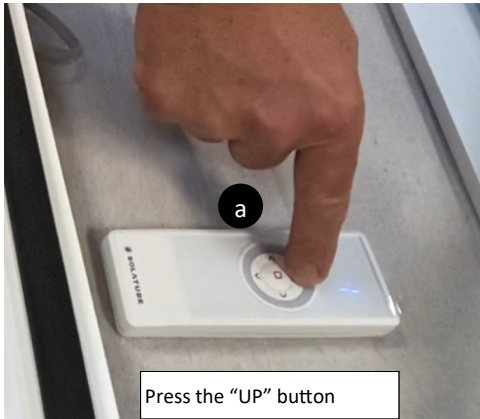

Press the "DOWN" button. Chain will go down.

**Pairing Complete**

**For further Remote Control instructions please see the Solatube Remote Control User Manual.**

# Notes



Solatube International, Inc.,  
2210 Oak Ridge Way, Vista CA 92081-8341  
Phone (800) 966-7652 • Fax (760) 599-5181  
[www.solatube.com](http://www.solatube.com) Part No. 952620 v1.2